

THROUGH-WALL GRADE METAL FLASHING A

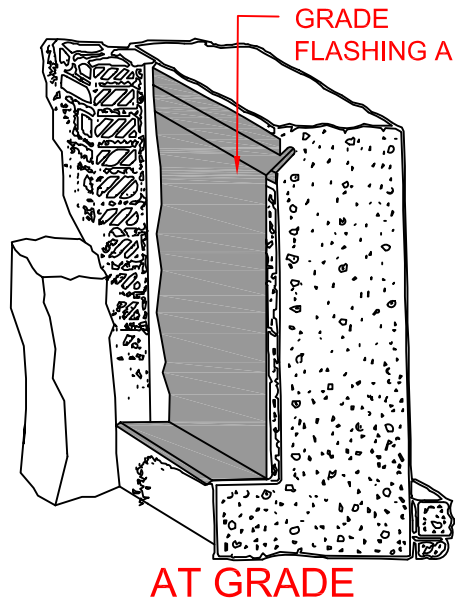
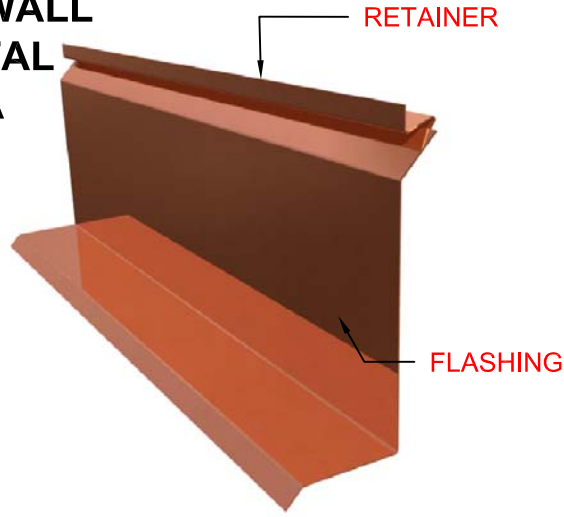

MATERIAL:

- COPPER 16 20
- STAINLESS STEEL 16 18 20
- 22 24 26
- LEAD COATED COPPER 16 20
- MILL FINISH ALUMINUM .019 .025 .032
- .040 .050 .063
- .080

DIMENSION:

FLASHING

- A QUANTITY[]
- B
- C
- D
- LINEAR FEET

*NOTE:
THE LINEAR FOOTAGE
OF THE RETAINER HAS
TO BE EQUIVALENT TO
THE LINEAR FOOT THE
FLASHING

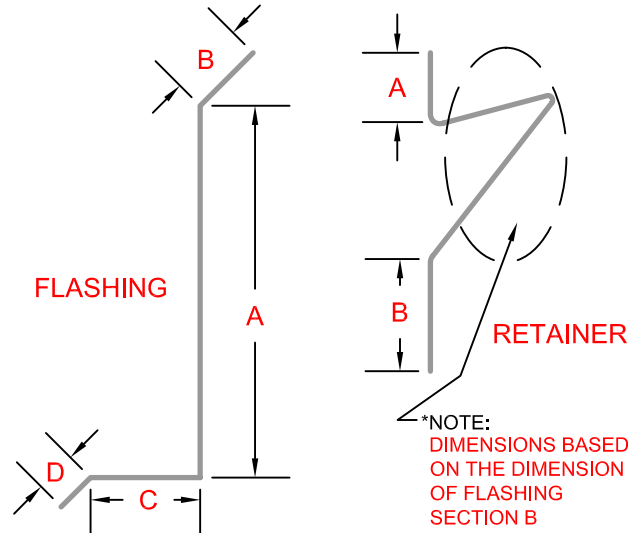
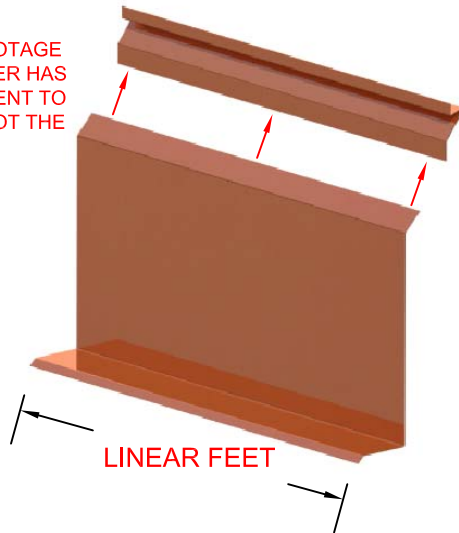

- NO RETAINER
- RETAINER
- A
- B

QUANTITY[]

ONCE THE FABRICATION BEGINS, ITEMS CAN NOT BE RETURNED. THE DETAILS FOR THIS JOB WERE CHECKED AND APPROVED BY: _____

B & B SALES REP

NAME: _____ SIGN: X _____

DATE: __/__/__



25-40 50 TH AVE.
LIC, NY 11101
P 718 433 2501
F 718 433 2709
info@bbsheetmetal.com
www.bbsheetmetal.com

COMPANY:

INVOICE:

PO#:

PROJECT:

INSTALLATION INSTRUCTION:

OTHER:

DATE:

DRAWING #:

FLASH-TWG01

PAGE(S):

1 OF 1

DRAWING BY:

NELSON SUT HO

APPROVED BY:

BOBBY BASCHNAGEL